

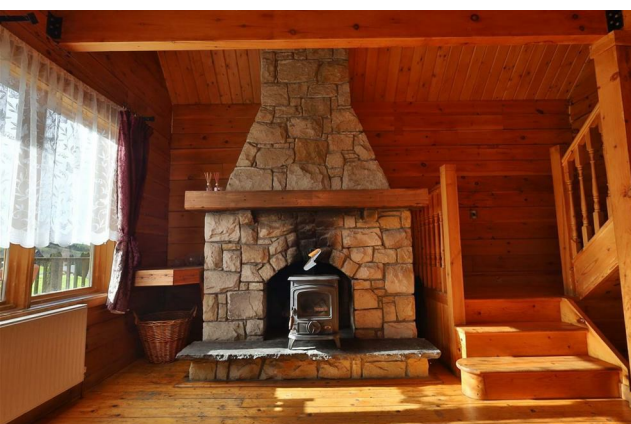

15 Lough Sillan Lodge, Shercock, Co. Cavan A81 CP82

€269,000







Raymond potterton & Co are delighted to Bring number 15 Lough Sillan Lodge located in a stunning waterside development along the shores of Lough Sillan.

This exquisite property offers luxurious living with breathtaking views of the lake and the surrounding unspoiled countryside.

15 Lough Sillan Lodge, Shercock, Co. Cavan A81 CP82

 1399.00 sq ft

 4 Bedrooms

 2 Bathrooms

INTRODUCTION

The residence features spacious interiors, modern amenities, and elegant design, ensuring comfort and style.

The complex offers a private jetty for its residences and provides direct access to the tranquil waters of Lough Sillan, perfect for boating, fishing, or simply enjoying the serene lakeside ambiance.

This exclusive development promises privacy, security, and a premium lifestyle in one of the most beautiful settings imaginable.

Commanding magnificent views over Lough Sillan and the unspoiled countryside, this location offers a tranquil and picturesque setting.

Whether you are looking for a peaceful retreat, an adventure in nature, or simply a place to enjoy the beauty of the outdoors, this area promises an unforgettable experience.

The serene waters of Lough Sillan, coupled with the lush, rolling hills of the surrounding countryside, create a perfect backdrop for relaxation and exploration. The property is in excellent condition and benefits from a Ber rating of C2.

The house is constructed with the finest Canadian logs providing warmth all year round.

The accommodation comprises of an open plan kitchen and living area, an upper lounge with breathtaking views.

The residence also offers three double bedrooms spread over the two floors, two bathrooms and multiple storage areas providing ample space for relaxation, entertainment, and enjoying the stunning surroundings of Lough Sillan. The development boasts an excellent tennis court and marina, providing a range of recreational activities right at your doorstep.

Shercock is within 1hr to Dublin Airport and 1.30hr Drive to Dublin via easily accessible road networks.





FIXTURES & FITTINGS

All flooring, curtains, furniture and appliances are included in the sale.

ACCOMMODATION

Kitchen / Living Area

15'3" x 28'10"

Wood flooring, feature kitchen with built-in appliances, stone fireplace with stove.

Hallway

Wood flooring.

Bedroom 1 (Ground Floor)

12'9" x 10'7"

Built-in storage, wood flooring.

Bedroom 2 (Ground Floor)

10'11" x 10'0"

Wood flooring.

Bathroom

6'11" x 4'1"

With Jacuzzi bath, w.c., w.h.b., fully tiled.

Multi Purpose Room / Bedroom - First Floor

15'3" x 27'1"

Wood flooring, French doors providing access to a south-facing upper balcony with stunning lake views, creating a bright and spacious living area.

Master Bedroom

13'1" x 12'9"

Sliding door access to a private rear balcony.

Ensuite

9'2" x 6'0"

Fully fitted bathroom with jacuzzi bath, feature shower, w.c., w.h.b., fully tiled.

FEATURES

- Large property extending to c.130 sqm
- Turnkey condition
- Private development
- Tennis Court
- Communal Marina
- Gas fired central heating
- Beautiful gated front entrance to the development
- Peaceful surroundings
- Stunning Views

DIRECTIONS

EIRCODE: A81 CP82



FLOOR PLAN

GROUND FLOOR



1ST FLOOR

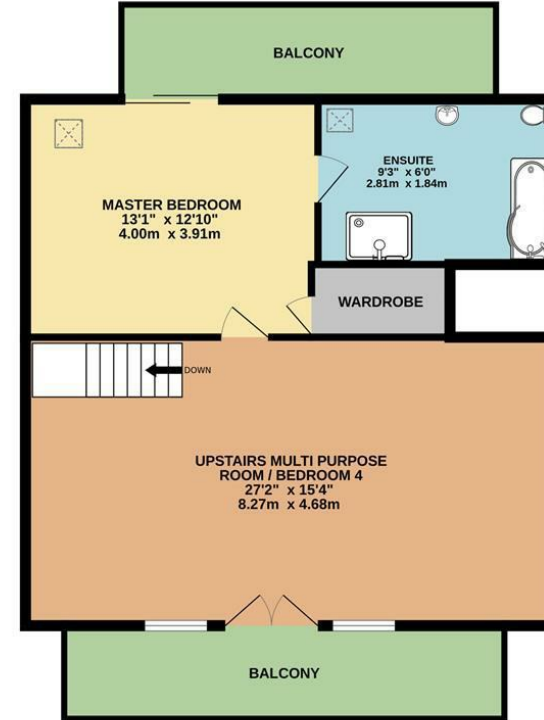

TOTAL FLOOR AREA: 1399sq.ft. (130.0 sq.m.) approx.

Whilst every attempt has been made to ensure the accuracy of the floorplan contained here, measurements of doors, windows, rooms and any other items are approximate and no responsibility is taken for any error, omission or mis-statement. This plan is for illustrative purposes only and should be used as such by any prospective purchaser. The services, systems and appliances shown have not been tested and no guarantee as to their operability or efficiency can be given.
Made with Metropix ©2026

