







No 86 is a 2 bedroom 3rd floor apartment located in the heart of Navan Town Centre in the secure development of Rivermill View.



86 Rivermill View, Navan, Co. Meath C15 TV04

 700.00 sq ft

 2 Bedrooms

 1 Bathrooms

INTRODUCTION

The property offer a bright and spacious accommodation with a large living area of the kitchen with the added bonus of a study. There are two double size bedroom with built in wardrobes.

The apartment is located in a block of 12 apartments with well maintained communal area.

FEATURES

- Located in Navan Town Centre
- Secure gated off-street parking
- Spacious bright apartment
- 2 Double Bedrooms
- No previous rent
- Management Fee €1580 per annum
- Qualitas Property Partners - Management Company

ACCOMMODATION

Entrance Hall

With wooden flooring.

Lounge

18'8" x 11'8"

With wooden flooring.

Kitchen/Diner

8'9" x 11'8"

With tiled flooring, wall to floor units, oven, hob, extractor fan, stainless steel sink, washing machine, dishwasher and fridge freezer.

Study

8'9" x 6'9"

With wooden flooring

Bedroom 1

12'2" x 11'4"

With wooden flooring and built in wardrobe.

Bedroom 2

9'0" x 8'11"

With wooden flooring.

Bathroom

7'4" x 5'7"

With tiled flooring, partly tiled walls, w.c, w.h.b, and shower.

FIXTURES & FITTINGS

All flooring, blinds and appliances included in the sale.

DIRECTIONS

From Dublin travel into Navan on the M3. Take the exit Junction 8 for Navan. In Navan at the third set of traffic lights turn right and Rivermill View is on the left-hand side. No.86 is located on the right hand side.



FLOOR PLAN

GROUND FLOOR

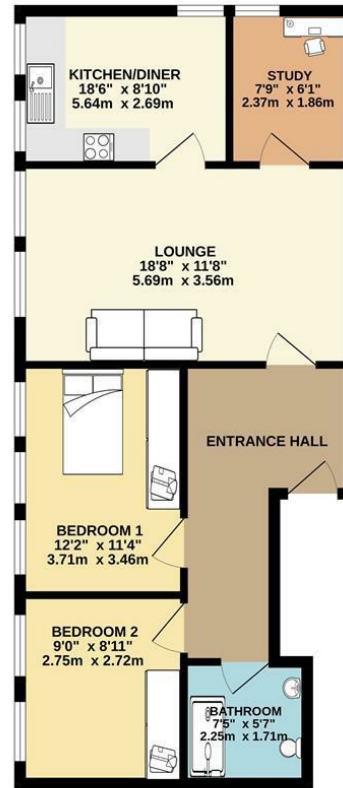

TOTAL FLOOR AREA: 790sq. ft. (65.0 sq.m.) approx.

Whilst every attempt has been made to ensure the accuracy of the floorplan contained here, measurements of doors, windows, rooms and any other items are approximate and no responsibility is taken for any error, omission or mis-statement. This plan is for illustrative purposes only and should be used as such by any prospective purchaser. The services, systems and appliances shown have not been tested and no guarantee as to their operability or efficiency can be given.

Made with Metropix ©2024

