



  
Raymond  
Potterton

21 The Steeples Navan Co. Meath C15 X220

€135,000

BER D2



21 The Steeples is an excellent investment opportunity ideally located in Navan Town Centre.

The property comes to the market, refurbished in recent years and in good condition.





# 21 The Steeples Navan Co. Meath C15 X220

 431.00 sq ft

 1 Bedrooms

 1 Bathrooms

## INTRODUCTION

No. 21 which is set on the ground floor is accessed by its own front door at ground level.

The Steeples is a popular residential development in the centre of the Town. It is walking distance to all the amenities in Navan Town.

Bright and spacious living accommodation of c.40 sqm. includes Entrance Hall, Kitchen, Lounge, 1 Double Bedroom and Bathroom.

## FIXTURES & FITTINGS

The property is sold as seen.

## FEATURES

- Town Centre Location
- Secure underground car parking
- Excellent investment opportunity
- Electric heating
- PVC double glazed windows

## ACCOMMODATION

### Entrance Hall

3'4" x 3'8"

With tiled flooring.

### Lounge

11'10" x 12'11"

With laminate flooring and blinds.

### Kitchen

5'3" x 9'1"

With tiled flooring, partially tiled walls, built in wall and floor units, fridge/freezer, extractor fan and washing machine.

### Hallway

2'11" x 9'10"

With laminate flooring and hotpress.

### Bedroom

9'5" x 12'0"

With laminate flooring and blinds.

### Bathroom

4'4" x 7'10"

With tiled flooring, partially tiled walls, w.h.b, w.c and bath.

## DIRECTIONS

From Dublin travel into Navan on the M3. Take the exit Junction 8 for Navan. In Navan at the third set of traffic lights turn left up Timmons Hill. The entrance to the Steeples is immediately after this turn on the left-hand side.

Eircode: C15 X220



GROUND FLOOR

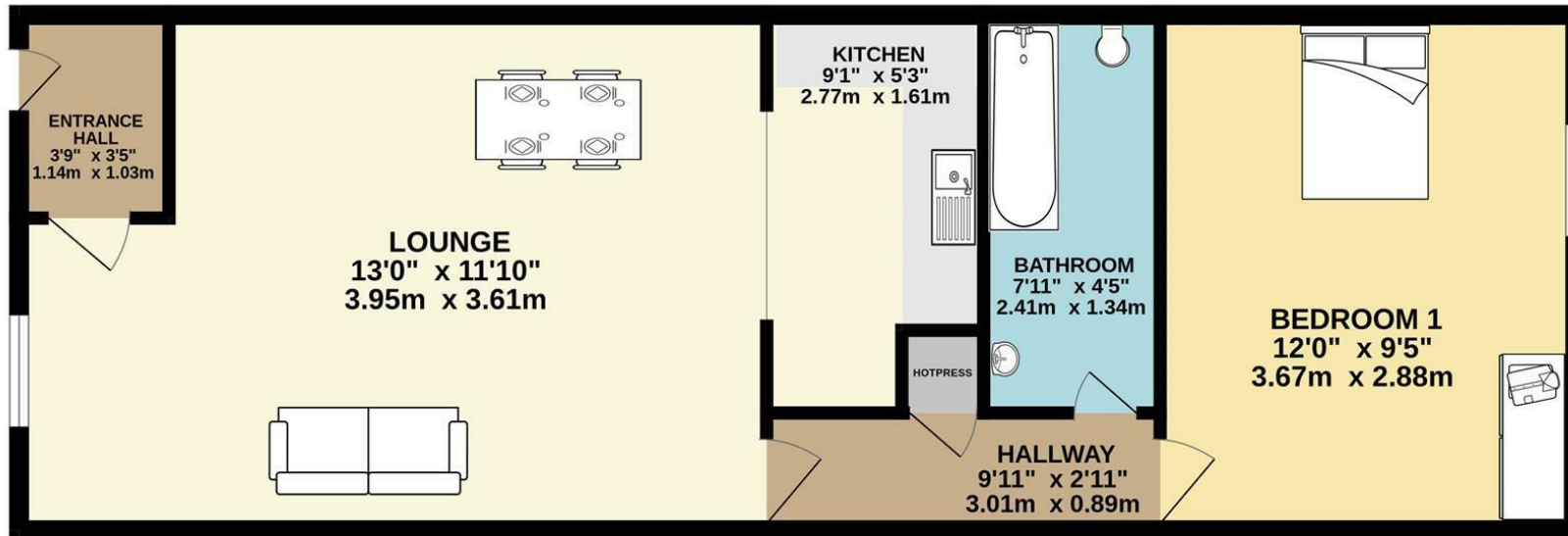

TOTAL FLOOR AREA : 431sq.ft. (40.0 sq.m.) approx.

Whilst every attempt has been made to ensure the accuracy of the floorplan contained here, measurements of doors, windows, rooms and any other items are approximate and no responsibility is taken for any error, omission or mis-statement. This plan is for illustrative purposes only and should be used as such by any prospective purchaser. The services, systems and appliances shown have not been tested and no guarantee as to their operability or efficiency can be given.  
Made with Metropix ©2024

