



Raymond
Potterton

19 Poolboy Quay Navan Co. Meath C15 VX64

€135,000

BER C3





A spacious one bedroom river view first floor apartment presented in excellent condition set in the Poolboy development located in Navan within walking distance of the town centre and all local amenities.



19 Poolboy Quay Navan Co. Meath C15 VX64

 498.00 sq ft

 1 Bedrooms

 1 Bathrooms

INTRODUCTION

This property has been repainted and is ready to go for new owners to be

The apartment is situated nicely in within the complex with excellent views of the River Boyne & Blackwater

Poolboy is a secure gated development with parking and is also located less than a three minute walk to the bus stop which services Dublin city centre on a regular basis.

There is excellent views of the town centre from the complex

Accommodation includes Entrance Hall, Kitchen / Dining area/ Lounge, 1 Bedroom and Bathroom.

FEATURE

- Excellent condition
- Ideal for first time buyers & investors alike
- Includes furniture and appliances
- Close to Navan Town Centre
- Spacious bright apartment

FIXTURES & FITTINGS

All flooring appliances and furniture is included with the sale

Entrance Hall

5 x 2.4

With wooden floor and hotpress.

Kitchen / Lounge

3.74 x 5.59

Kitchen with tiled floor, partly tiled walls, built in wall and floor units, oven, hob, extractor fan, fridge, dishwasher and washing machine. Open plan to Lounge with wooden flooring and patio doors to the balcony.

Bedroom

3.02 x 3.20

With wooden flooring and built in wardrobes.

Bathroom

1.84 x 2.73

With tiled flooring, partly tiled walls, w.c., w.h.b and bath.

DIRECTIONS

From Dublin travel into Navan on the M3. Take the exit Junction 8 for Navan. In Navan at the 4th set of traffic lights turn right and Poolboy is located on the right-hand side on Flowerhill



FLOOR PLAN

GROUND FLOOR

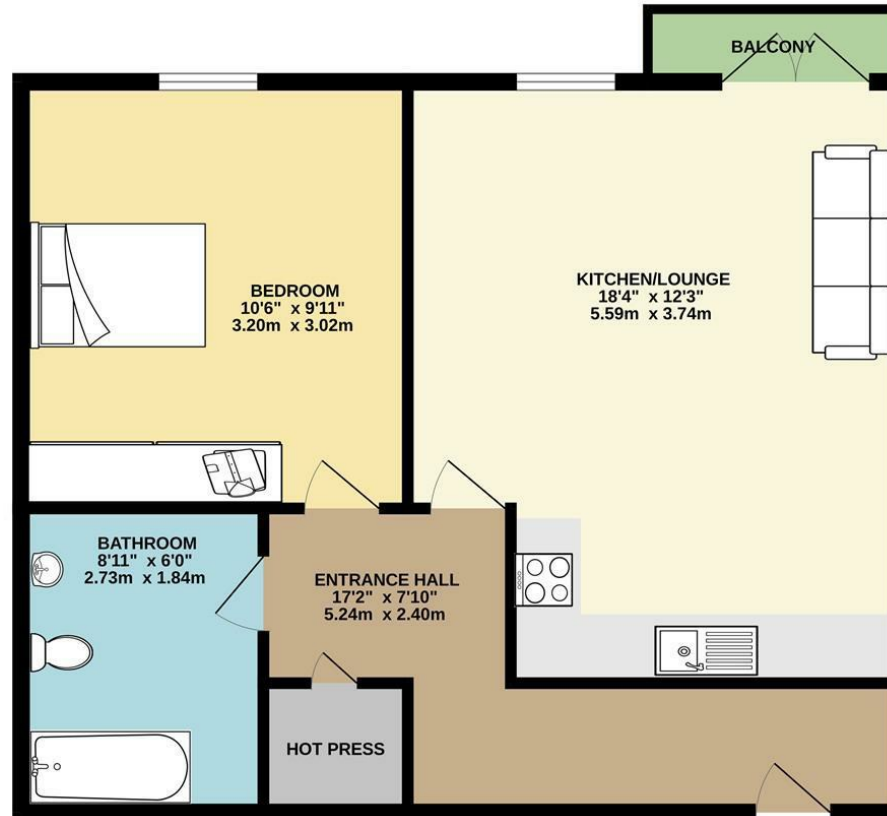

TOTAL FLOOR AREA : 498sq.ft (46.3 sq.m.) approx.

Whilst every attempt has been made to ensure the accuracy of the floorplan contained here, measurements of doors, windows, rooms and any other items are approximate and no responsibility is taken for any error, omission or mis-statement. This plan is for illustrative purposes only and should be used as such by any prospective purchaser. The services, systems and appliances shown have not been tested and no guarantee as to their operability or efficiency can be given.
Made with Metropix ©2023