





Located in a quiet cul de sac location in Spire View Lawn No 15 is a spacious 4 bedroom semi detached residence which occupies a prime elevated end site.

The accommodation is well proportioned and is an ideal family home.

15 Spire View Lawn Navan Co. Meath C15 FNW6



1250.00 sq ft



4 Bedrooms



3 Bathrooms

INTRODUCTION

Located close to Johnstown Village, the Bailis Shopping Centre and close to all local amenities. Navan Town centre is a 5 minute drive and this property enjoys easy access to the M3 motorway providing excellent access to Dublin City.

Accommodation includes Entrance Hall, Lounge, Kitchen / Dining, Utility, Guest W.C., 4 Bedrooms (Master Bedroom Ensuite) and Family Bathroom.

FIXTURES & FITTINGS

All flooring, blinds, light fittings, appliances and garden shed are included in the sale.

FEATURES

- Gas fired central heating (Upgraded)
- Landscaped rear garden
- Gated side entrance
- Garden Shed
- PVC double glazed windows
- PVC fascia and soffit

DIRECTIONS

From Dublin travel along the M3 into Navan. Exit at Junction 8. At the roundabout take the 2nd exit toward Dublin. At the traffic lights turn left. Take the second right opposite the IDA Industrial Park. Continue straight past Boyne View into Spire View. In Spire View take the first left turn and the next left turn and the property is located on the right hand side identified by our for sale sign.



FLOOR PLAN

GROUND FLOOR

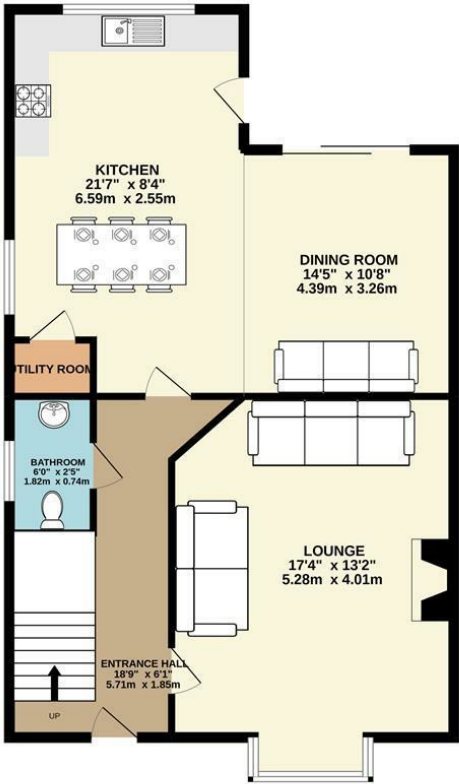

1ST FLOOR

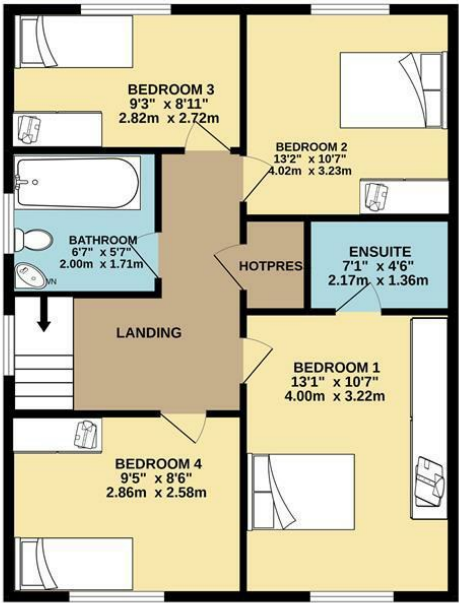

TOTAL FLOOR AREA : 1249sq.ft. (116.0 sq.m.) approx.
Whilst every attempt has been made to ensure the accuracy of the floorplan contained here, measurements of doors, windows, rooms and any other items are approximate and no responsibility is taken for any error, omission or mis-statement. This plan is for illustrative purposes only and should be used as such by any prospective purchaser. The services, systems and appliances shown have not been tested and no guarantee as to their operability or efficiency can be given.
Made with Metropix ©2022